

# HG-FLG-7 Laser Sight & Tactical Light Combo

## Features

- a. Laser sight and tactical light combination.
- b. equipped with Picatinny Rail for mounting other gun accessories.
- c. self-latching battery door design to avoid unintentional missing.

## Structure

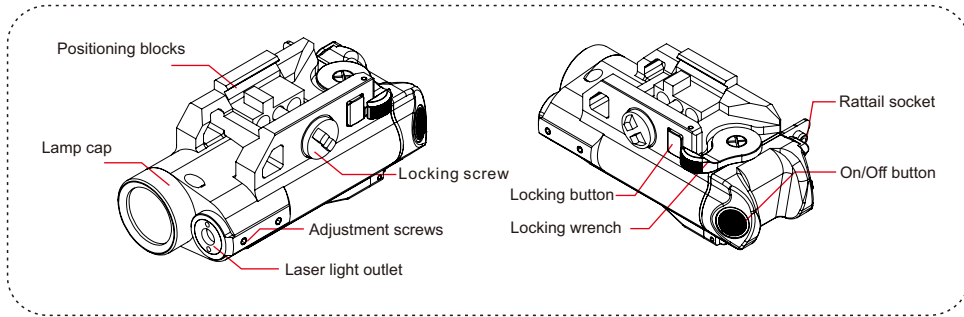

## Model Family(s) & Specification

HG-FLG-7 ( Green Laser Sight And Tactical LED Light)	
HG-FLR-7 (Red Laser Sight And Tactical LED Light)	
Green Laser	510-532nm, <5mW, Class 3A
Red Laser	635-660nm, <5mW, Class 3A
LED Output	3w 100lum
Material	Aviation aluminum 6061-T6
Dimension	88(L)*40(W)*40(H)/mm
Net Weight	115g
Battery Type	CR123A(2pcs) 3V 1300mAh/ICR123A(2pcs) 3.7V 1300mAh

## Delivery Sets

- Laser Sight and LED combo
- Pressure switch
- Wrench
- User manual

## Battery installation

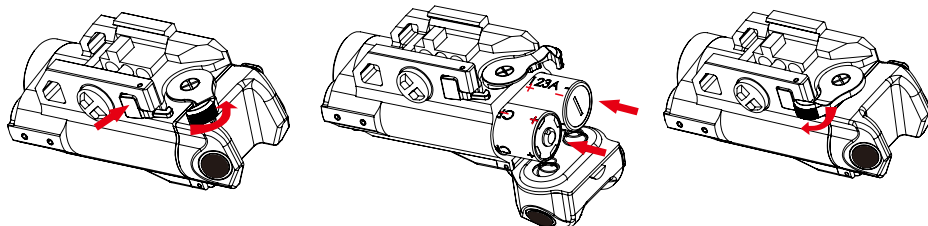

- a. Press the locking buckle and push the locking wrench to open the battery cover.
- b. Place the battery into the battery compartment in the specified direction.
- c. Tighten the locking wrench to lock the battery cover and complete the installation.

## Mounting

**WARNING:** After first checking to insure that weapon is unloaded and has no ammunition in the chamber.

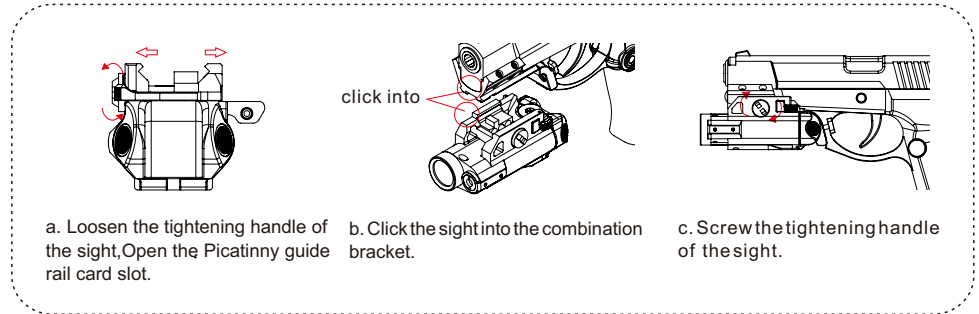

## Operating Instruction

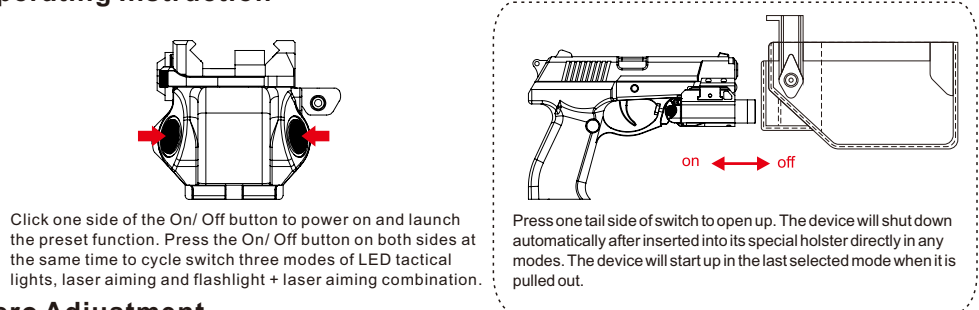

Click one side of the On/ Off button to power on and launch the preset function. Press the On/ Off button on both sides at the same time to cycle switch three modes of LED tactical lights, laser aiming and flashlight + laser aiming combination.

Press one tail side of switch to open up. The device will shut down automatically after inserted into its special holster directly in any modes. The device will start up in the last selected mode when it is pulled out.

## Zero Adjustment

1. Fix the laser sight to the barrel on a weapon.
2. Place the weapon in a vise or on a shooting bench.
3. Place a target about 30m away.
4. The next step assumes that the weapon's iron sights or other sighting system is correctly zeroed for 30m. If not, turn the laser off and fire 5 rounds at the target to see the point of impact grouping. If necessary, adjust your sights to the correct point of impact.
5. Take aim again using the exact same sight picture as in step #4. Turn on the laser sight and you will see the difference in distance between the laser dot and the real point of impact. To adjust the laser to be point of impact, the windage and elevation will need to be adjusted. Rotating the windage and elevation with Allen wrench to adjust the laser.
6. Now use the laser sight, aim at the target, and shoot another group of 5 rounds. If the point of the laser is near the points of impact, then the zero adjustment has been accomplished.

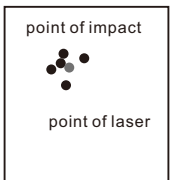
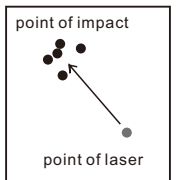

## Safety Precautions

- Direct viewing of the laser is hazardous to the eyes.
- Never look directly into the laser beam.
- Never point laser beam at person.
- Do not allow children to use laser sight unless under adult supervision.



**Warning:** Laser beam is forbidden to shoot eyes and skin directly, blindness and burn will be caused.